

AMS2000MH/3000MH(-K)

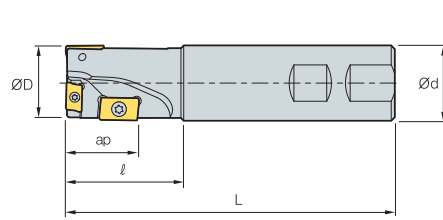

Fig. 1

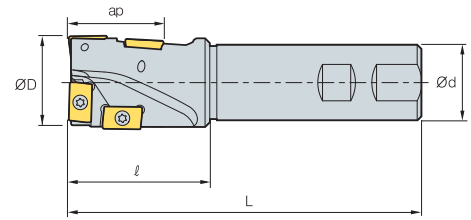

Fig. 2



• AR: 9°~12°
• RR: -12°~-10°

(mm)

Designation		ØD	Ød	l	L	ap		APMT 0602	APMT 0903	APM(X)T 11T3 -	APMT 1604	APKT 1604 -	Fig.
AMS 2025MH	3	25	25	40	130	20	0.45	-	-	3	-	-	1
2032MH	3	32	32	50	140	30	0.75	-	-	1	2	-	1
AMS 3040MH	4	40	32	60	150	40	0.90	-	-	-	4	-	2
3040MH-K	4	40	32	60	150	40	0.90	-	-	-	-	4	2

Available inserts



Type	Designation	Cermet		Coated										Uncoated	page					
		CN2000	CN30	NCM325	NCM335	NC5330	NCM535	NCM545	PC2505	PC2510	PC3600	PC3700	PC6510	PC9530		PC9540	PC5300	PC5400	H01	
2000 type	APMT 11T3PDFR-MA																			
	11T308PDFR-MA																			
	11T3PDER-ML																			
	11T308PDER-ML																			
	11T3PDSR-MM			●		●	●		●	●	●	●	●		●	●				
	11T3PDSR-MF					●				●	●	●			●	●				
	11T308PDSR-MM					●				●	●		●	●	●	●				
	11T312PDSR-MM					●				●	●		●	●	●	●				
	11T316R-MM					●				●	●		●	●	●	●				
	11T318R-MM					●				●	●		●	●	●	●				
11T324R-MM					●				●	●		●	●	●	●					
3000 type	APMT 1604PDSR-MM			●		●			●	●	●	●	●	●	●	●				
	1604PDSR-MF					●				●	●	●		●	●					
3000-K type	APKT 1604PDSR-MM			●	●							●	●	●						
	1604PDSR-MF			●								●	●	●						

Parts

Specification			
	Screw	Wrench	Wrench
Ø25 (2000 type)	FTKA02565S	TW08S	-
Ø32 (2000 type)	FTKA02565S+FTKA0410	TW08S+TW15S	-
Ø40 (3000 type)	FTKA0410	TW15S	-

Available inserts E04, E05

Recommended cutting condition

	Drilling	Shouldering	Slotting
vc (m/min)	80~200	80~200	80~200
fz (mm/t)	0.03~0.06	0.05~0.25	0.05~0.20

• Please keep the drill depth under 0.25D when you're drilling
• Please keep the step depth from 0.2 to 0.3mm

